



DURANGO

1500



Come home to KZ!

www.kz-rv.com



DURANGO

1500

Light weight and beautifully appointed, there's a model just right for you.



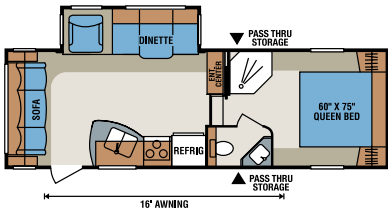

D245RL

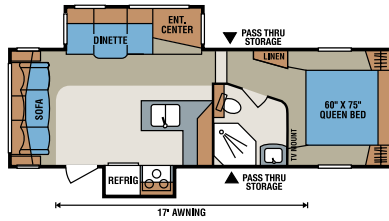

D245SB • Wardrobe Closet Slide Option – see below

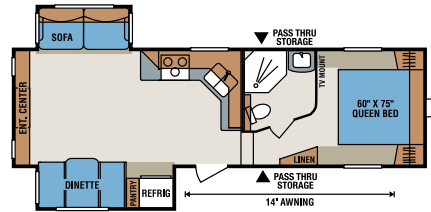

D275RE

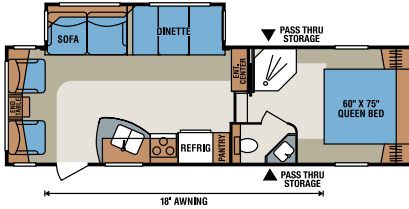

D275RL • Wardrobe Closet Slide Option – see below

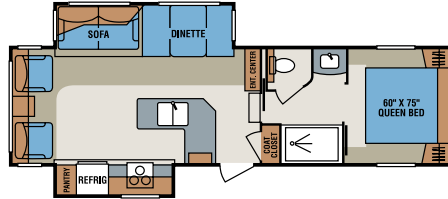

D2857

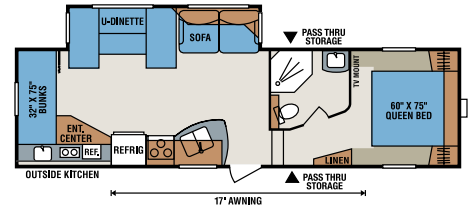

D295BH

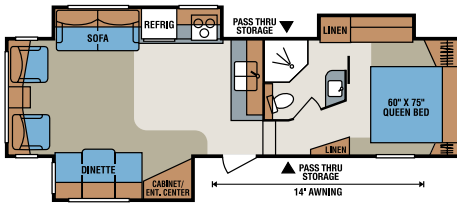

D295CS

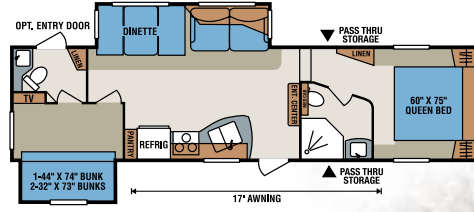

D296BH

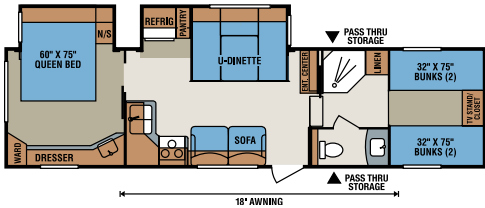

D305BH

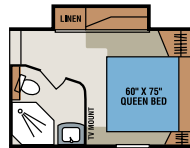

D245SB
Wardrobe Closet Slide Option

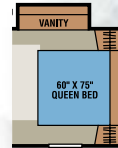

D275RL
Wardrobe Closet Slide Option



1500 FIFTH WHEELS	D245RL	D245SB	D275RE	D275RL	D2857	D295BH	D295CS	D296BH	D305BH
UVW (Unloaded Vehicle Weight)*	6,600	7,153	7,258	7,158	8,220	7,475	8,128	8,158	8,102
Dry Hitch Weight*	1,320	1,317	1,206	1,105	1,170	1,325	1,375	1,208	1,305
Dry Axle Weight*	5,280	5,836	6,052	6,053	7,050	6,150	6,753	6,950	6,797
NCC (Net Carrying Capacity)	2,200	1,647	1,542	1,642	1,780	1,325	1,672	1,642	1,698
GVWR	8,800	8,800	8,800	8,800	10,000	8,800	9,800	9,800	9,800
Exterior Height	143"	144"	143"	143"	144"	144"	144"	145"	144"
Exterior Width	96"	96"	96"	96"	96"	96"	96"	96"	96"
Exterior Length	27' 3"	27' 11"	29' 8"	29' 4"	31' 8"	31' 9"	31' 11"	33' 11"	34' 1"
Refrigerator (cu. feet)	6	6	6	6	6	6	6	6	6
Water Heater Cap. (gal. G/E w/DSI)	6	6	6	6	6	6	6	6	6
Fresh Water Cap. (gal.)	55	55	55	55	55	55	55	55	55
Waste Water Cap. (gal.)	32	32	32	32	32	32	32	32	32
Gray Water Cap. (gal.)	32	32	32	32	32	32	32	32	32
LP Gas Cap. (lbs.)	60	60	60	60	60	60	60	60	60
Furnace BTUs (1,000s)	30	30	30	30	30	30	30	30	30
Tire Size	15"	15"	15"	15"	15"	15"	15"	15"	15"
Awning	16'	16'	14'	18'	15'	17'	14'	17'	18'

*This weight reflects the rolling average unit weight for each model.
Your trailer weight will vary according to optional equipment.

2012 Durango 1500 Cut-Away



Coach-Net®

RV Membership Plans

One Year **FREE**
Road Side Assistance
courtesy of KZ!

- | | | |
|---|--|---------------------------------------|
| 1 13,500 BTU A/C | 17 Large capacity pass-thru storage with bus style slam latch doors | 32 Exterior security/Scare lights |
| 2 1 piece seamless roofing material | 18 Heavy duty I-beam frame construction | 33 Snap jacks pull pins |
| 3 3/8" decking | 19 R-7 batten insulation | 34 Extra long drip spouts |
| 4 Vinyl interior ceiling panel | 20 2x3 floor joist, 16" O.C. | 35 Satellite preparation |
| 5 4 3/8" truss rafter, 16" O.C. | 21 Heated & enclosed underbelly | 36 Exterior speakers |
| 6 R-14 batten insulation | 22 Insulated and heated water tanks | 37 Dexter NEV-R-ADJUST™ Brakes |
| 7 Insulated ductwork | 23 Fully welded outriggers | |
| 8 Exterior clearance and brake lights | 24 5/8" tongue & groove plywood | |
| 9 One-piece fiberglass front cap | 25 Heavy duty leaf springs | |
| 10 Expanded Polystyrene – R-9 | 26 Heavy duty steel wheels | |
| 11 Fiberglass exterior with integrated luan backing | 27 Residential style carpet pad | |
| 12 1/8" luan decorative wall board | 28 Rack and pinion electric slide with manual override with 2x2 tube slide out ram | |
| 13 1/8" luan wall board | 29 Residential carpet or linoleum | |
| 14 3" aluminum framed sidewall | 30 Tinted safety glass windows | |
| 15 Residential style ducted heat run in floor | 31 Triple sealed slide outs | |
| 16 Darco® moisture barrier | | |





D275RE

Lots of workspace and storage characterize this spacious kitchen design that features a deep basin sink with hi-rise faucet, and matching range, micro and vent hood.



A spacious walk-thru bath, equipped with full sized shower and a vanity with lighted mirror is conveniently located adjacent to the bedroom. Retire to the comforts of a large bed featuring an upholstered headboard accented by dual mirrored wardrobes and overhead cabinets.

Basil Décor

Mink Décor

Walnut Décor

Standards

Front Cap
Stabilizer Jacks
Awning with Drip Rail and Spouts
Microwave with Turn Table
13,500 BTU Ducted A/C
Enclosed Pin Box
Security Light
6 Gallon Gas/Electric DSI Water Heater
Skylight Over Tub
Pillows for Sofa
Wire for Satellite
Heated Tanks and Enclosed Underbelly
Tinted Windows
Black Tank Flush System
Power Jacks
6 Cubic Foot Refrigerator with Black Glass Insert
32" LCD TV
Assist Grab Handle
Night Shades
AM/FM/CD/DVD Player with USB Port

Porcelain Toilet
Outside Speakers
Innerspring Mattress
Roller Ball Bearing Drawer Guides
Dexter **NEV-R-ADJUST™** Brakes
Gas Struts on Bed Base
Wrought Iron Accents on Valances
Outside Shower
Bus Style Slam Latch Baggage Doors

Options

Partial Paint Package
Countertop Extension
Hide-A-Bed
Table and Chairs with Leaf
Recliner – 1 or 2
2 Barrel Chairs IPO Sofa (D245SB Only)
8 Cubic Foot Refrigerator
Fireplace (N/A on D275RL)
Dyson® Vacuum
Fan-Tastic Vent® (Bedroom and Bathroom)
15,000 BTU A/C (IPO 13,500 BTU A/C)

Ladder
Power Awning
Aluminum Wheels
Bike Rack/Cargo Carrier
Dexter E-Z Flex® Heavy Duty Rubber Suspension
Outside Grill
Spare Tire/Carrier/Cover
Sidewinder Hitch
Wardrobe Slide (D245SB and D275RL Only)
Flip Up Bunk with Jiffy (D296BH Only)
Entry Door in Bathroom (D296BH Only)
Katching ZZ's Mattress Upgrade

Road Trip Package

Aluminum Wheels
Dexter E-Z Flex® Heavy Duty Rubber Suspension
Spare Tire/Carrier/Cover
Ladder
Power Awning
8 Cubic Foot Refrigerator
Innerspring Mattress



Bike Rack



Cargo Carrier

The optional Bike Rack/Cargo Carrier offers you even greater versatility for those “extra” items you don’t want to leave at home.



*Optional
Dyson®
Vac*

ASK ABOUT OUR 2-YEAR LIMITED WARRANTY!



Dealer Satisfaction Index:
Ratings of manufacturers, by dealers, have consistently awarded KZ top honors for excellence of design, reliability, overall quality and value, communications and dealer support.

Dealer:



Portions of this brochure were used with the expressed authority of Dexter Axle, but Dexter Axle is not responsible for the accuracy of the information contained herein.

For more product details and in-depth information, visit us on the web at **www.kz-rv.com**

0985 N 900 W • Shipshewana, IN 46565
E-mail kz@kz-rv.com • www.kz-rv.com

Due to continual research and advances, manufacturer reserves the right to change specifications, design, price and equipment without notice, and assumes no responsibility for any error in this literature. Some items shown are not included as standard or optional equipment.

©2011KZ | 10/14/11 | 25M